

## Flower Field Hall

Nestled within the Flower Dome, Flower Field Hall engages guests with a sensory experience. Guests will have a memorable time marvelling at the uniqueness of events held here. Overlooking the changing Flower Field display on one side, and a spectacular view of the Marina Bay skyline on the other, this indoor space captivates with its picturesque backdrop of perpetual spring. Specially programmed LED lights add to the enchanting setting by cycling through a rainbow of colours.

### Suitable for

- Fashion Shows
- Gala Dinners
- MICE Events
- Product Launches
- Special-themed Events
- Weddings

### Transport/Access

- Chauffeur-driven Garden Cruisers can be pre-arranged to ferry guests to the venue.
- Nearest carpark is Main Gate Basement Carpark with 407 carpark lots.
- About a 5-minute walk from the Visitor Centre, Coach Bay and Main Gate Basement Carpark.
- About a 10-minute walk from Bayfront MRT Station.



# FlowerField Hall

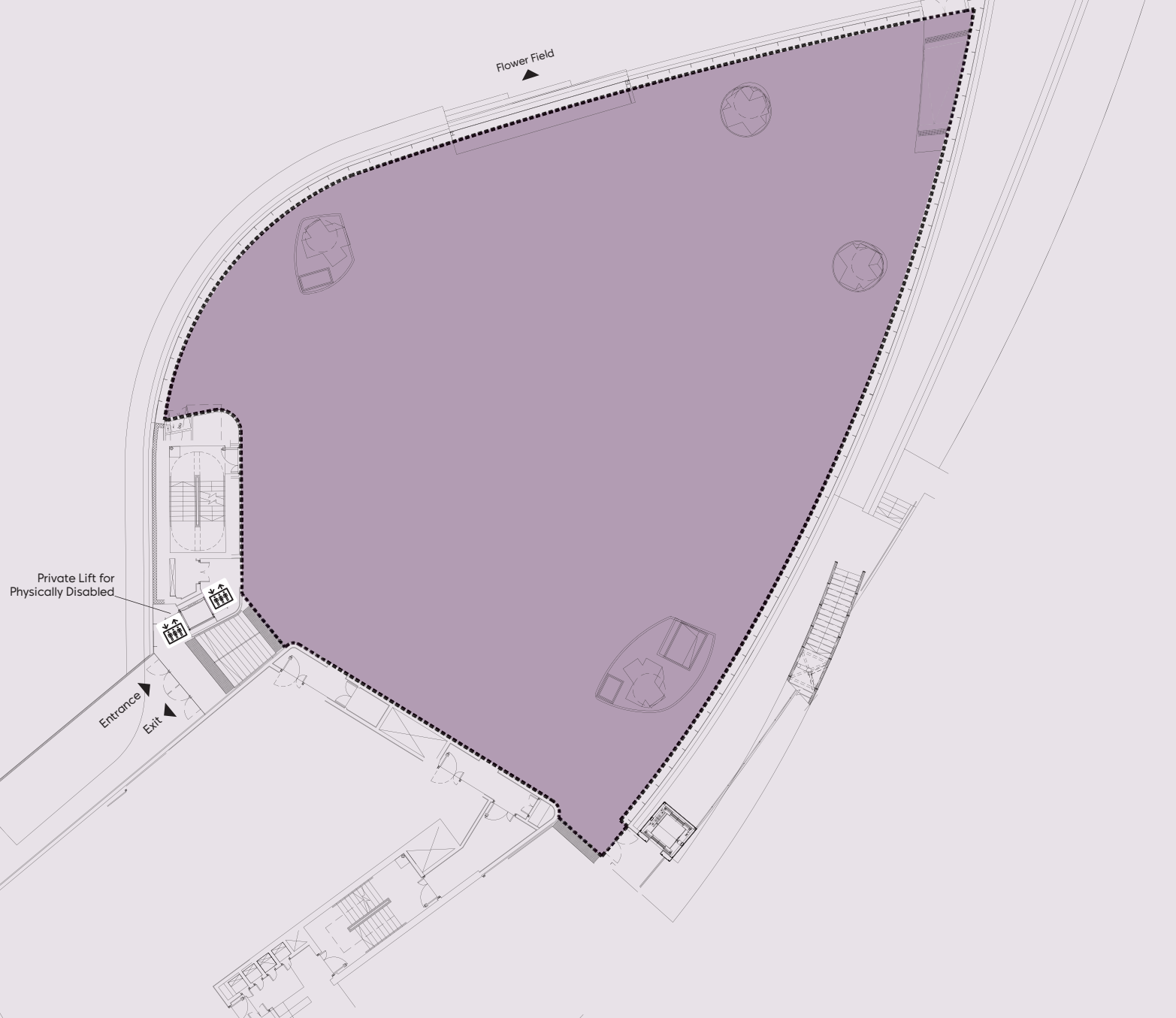

## LOCATION



### Size

- 1,200 square metres

### Capacity

- Up to 1,100 guests (standing cocktail)
- Up to 800 guests (theatre seating)
- Up to 700 guests (sit-down dinner)

### Facilities

- Exclusive entrance to Flower Dome.
- Private hospitality desk for guest registration.
- Exquisite VIP holding room with fully furnished facilities and ensuite bathroom can be pre-arranged.
- Basic sound system, projectors and projection screen.
- Well-equipped kitchen for on-site cooking (Chinese and Western banquet) and food preparation area.
- Exclusive washrooms for guests.
- Private lifts for guests and the physically disabled.
- Loading/unloading lifts.