

Annex B: Shuttle Service during Singapore Garden Festival (23-31 July 2016)

The biennial Singapore Garden Festival – Asia's premier tropical garden and flower show – returns as the most extensive edition ever, from 23 to 31 July 2016. Jointly organised by National Parks Board and Gardens by the Bay, this year's festival is the largest to date, stretching over 9.7 hectares at Gardens by the Bay – from The Meadow to Bayfront Plaza to the Flower Dome.

Expanded shuttle route

To cater to the extensive festival grounds, the Gardens' shuttle route will be expanded. The 2.5-km route will have four shuttle stations (instead of the usual two) to allow visitors easier access to the key locations of the festival.

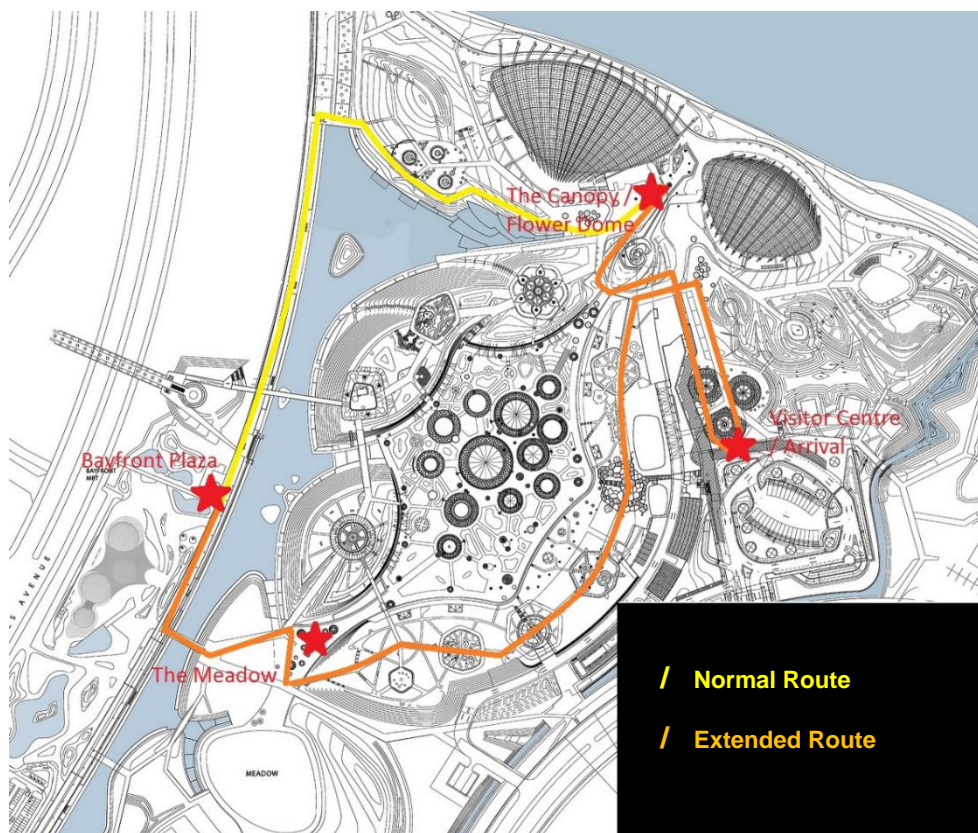

Free shuttle rides for seniors

Seniors 60 years old and above will enjoy free shuttle rides during the festival. To enjoy the free rides, seniors have to show their IC (for locals) or passport (for foreigners) to the ushers at the shuttle stations.

Operating Hours (23-31 July)

- Daily, 9am - 10pm

Ticketing (23-31 July)

- \$3 for unlimited rides in the same day
- Free for wheelchair passengers occupying the wheelchair carriage
- Free for seniors 60 years and above (IC/passport required)
- Tickets can be purchased at the four shuttle stations